



Elementary Principal's Report Board of Education Meeting

March 1, 2010

A Look Back at February Activities:

3-D Drawing Adventure Assembly by Mark Kistler

- ✦ Mr. Kistler held two assemblies with Elementary students. Mr. Kistler has starred in many television series such as *The Secret City*, *The Draw Squad*, *The New Secret City Adventures*, and his most recent, *Mark Kistler's Imagination Station* which airs on PBS. Mark has also written and illustrated many popular children's drawing books.
- ✦ The visit by Mark Kistler was funded through a Ashland Greenwood Foundation Grant submitted by Cori Lightfoot and the PTO.

Field Trips

- ✦ 4th and 5th Grades attended *Machines in Motion: Contributions by Leonardo da Vinci* at SASM
- ✦ 6th Grade attended *Concerts for Youth* at the Holland Center

Kindergarten Parent Meeting held February 11th

- ✦ 48 students have begun the enrollment process.

Young Authors Celebration

- ✦ 21 students recognized for their excellent writing

5th Grade D.A.R.E. Graduation

- ✦ The DARE program addresses several objectives in the Health curriculum.

6th Grade Science Fair

- ✦ 18 students will compete at the regional Science Fair at SASM in March

NeSA-Reading

- ✦ 3rd-6th grade students have completed the practice test in preparation for the April testing.

Jays Club – 4th-6th Grade After-School Program

- ✚ The purpose of the after school club is to provide instruction and practice activities in the areas of reading and math in a fun and supportive environment. Five teachers (volunteers) and two paras work with 27 students after school on Mondays and Wednesday for one hour each day.

 - ✚ Students are learning and practicing math concepts and skills through an economy program where students apply for jobs, earn 'money', pay expenses and purchase items from the Jays Club store. Estimation, computation, and counting back change are just some of the skills being practiced.
- In the area of reading, students are being taught:
- fluency skills
 - how to select a 'good fit' book
 - and are being provided small group and individual tutoring
- ✚ This program is a part of our Academic Support and Achievement Program (ASAP) and is intended to help close the learning gap for students from lower socio-economic and diverse backgrounds (though the program may serve others as well).

 - ✚ The program will continue through the end of April.

February 26, 2010

Ashland-Greenwood School Board
1225 Clay Street
Ashland, NE 68003

Mr. Pease, Mr. Jacobsen, and School Board Members:

It is with both regret and anticipation that I submit this letter of resignation, effective 2010 school term. I have accepted a teaching position at Syracuse High School, an opportunity that not only allows me to be closer to home, but to further challenge myself with new curriculum opportunities.

It has been a genuine pleasure this past 9 years to work for Ashland-Greenwood School District. I have been blessed to be part of this district. When I look over my time here, I realize how much I have grown. I have enjoyed working with the amazing staff of professionals and colleagues, and will miss my associations here. I wish you and Ashland-Greenwood School District continued success. Although I'll be wearing green full-time now, know that I will always have a little blue running through my veins.

If I may be of any assistance in the hiring process or training of my replacement, please know that I will gladly make myself available.

Thank you for allowing me to serve the Ashland-Greenwood School District.

Sincerely

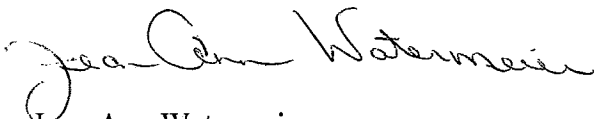

Jean Ann Watermeier
2529 J Rd.
Syracuse, NE 68446

City of Ashland, NEBRASKA

APPLICATION FOR WELL PERMIT

Date of Application 2-16-2010 Permit No. _____

Address or Location: 1842 Furnas Street, Ashland, NE

Legal Description: Parcel ID 004919000
Blk 1 School District Addition to Ashland

Fee: _____ Receipt No. _____

Location and purpose of the well:

The well will be ^{over 1,000} _____ feet from the nearest municipal, irrigation, or industrial well. The nearest well is owned by _____ you other.

Is this a new well? Yes Is this well to replace an existing well? No _____

Name and address of well driller: Loop Tech International, Ltd.
2928 SH 19 Huntsville, TX 77320

The well is intended to be used for: closed loop, Geothermal well field

Well and Pumping specifications: (include depth, diameter of casing, static level, depth of water during normal pumping conditions, pump column)

120 wells x 200' deep with 3/4" SDR polyethylene pipe loops

Petitioner Address and Telephone: Ashland-Greenwood Public Schools

Petitioner Signature: *Craig Pease* Print: CRAIG PEASE

City Council Meeting Date _____ Approved _____ Denied _____

Recommendations/Conditions _____

(Please include a rough drawing of location of well. Mark spot for new well with an X.)

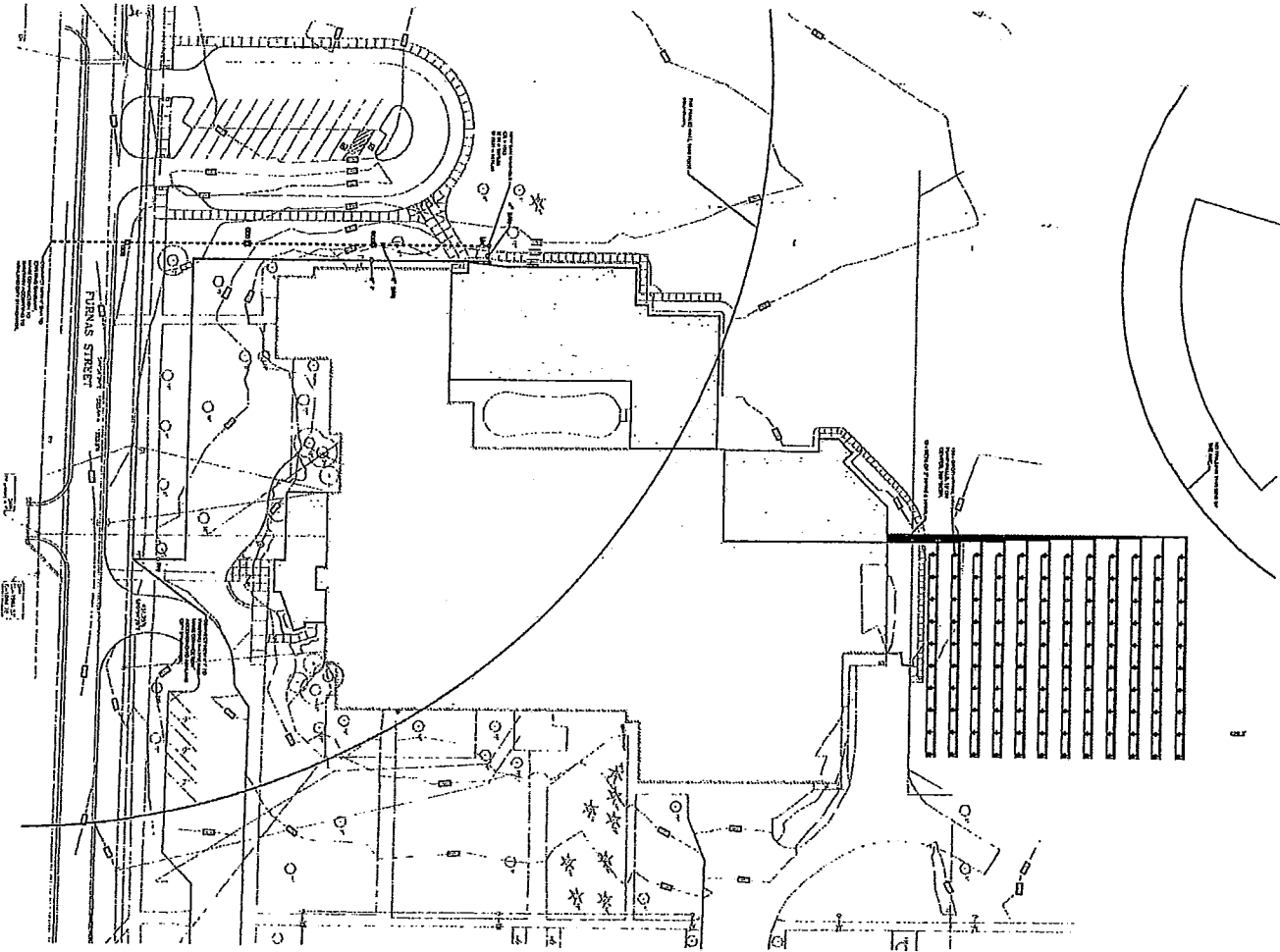
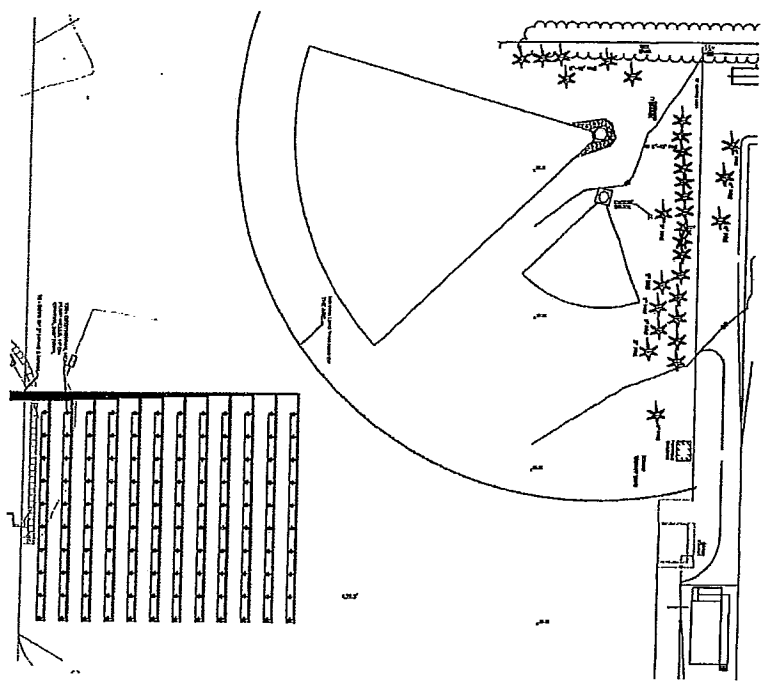
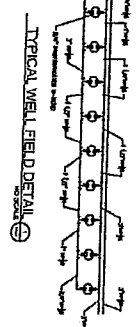
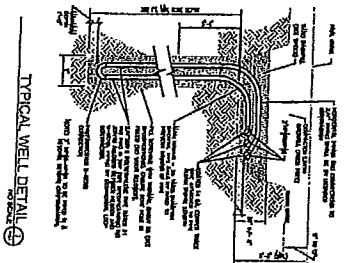

MS-1



ASHLAND-GREENWOOD HIGH SCHOOL

2010 ADDITION/REMODEL PROJECT

1545 FURNAS STREET, ASTORIA, OREGON 97103

ENGINEER: CLAUDIO GONZALEZ GARDNER ARCHITECTURE LANDSCAPE ARCHITECTURE INTERIOR DESIGN CONSTRUCTION MANAGEMENT

REVISION			
NO.	DESCRIPTION	BY	DATE
1	FIELD FIELD MARKING REV.	PSD	10/27/10





Message

Thu, Feb 11, 2010 5:30 PM

From:  "Rick Wintermute" <rickw@kccobuilders.com>

To:  Craig Pease

Subject: FW: Ashland Driller's Log

Craig,

Sorry, I neglected to include you on this email

rick

-----Original Message-----

From: Rick Wintermute
Sent: Thursday, February 11, 2010 5:30 PM
To: 'Nelson Link'; 'Paul Kelly'; Wayne Borer; Ext Bob Dana
Subject: FW: Ashland Driller's Log

TEAM,

Here are the drilling logs from the test well

rick

-----Original Message-----

From: Tim Boonstra [mailto:tim@looptech.net]
Sent: Thursday, February 11, 2010 4:22 PM
To: Rick Wintermute
Cc: Ralph Cadwallader; Russell Buras; Ely
Subject: Ashland Driller's Log

Rick,

Here is the driller's log for Ashland:

0-20' - Brown Dirt

~~20'-85' - Sand~~

85'-95' - Gray Clay

95'-110' - White Shale

110'-115' - Red Clay

115'-125' - Limestone

125'-130' - Red Clay

130'-135' - Gray Clay

140'-165' - Limestone

165'-175' - Gray Clay

175'-188' - Limestone

188'-194' - Gray Clay

194'-200' - Bed Rock

200'-205' - Gray Clay

Please forward to the interested parties and call with any questions. We will return next week to perform the thermal conductivity testing.

Thanks.

§3-115 POLLUTION

It shall be unlawful for any person to pollute or attempt to pollute any stream or source of water for the supply of the Water Department. (Neb. Rev. Stat. §17-536)

§3-116 MANDATORY HOOKUP; WELLHEAD PROTECTION

(1) All persons within the City's corporate limits or one mile thereof who are within 300 feet of a water main shall be required, upon notice from the City Council, to hook up with the city water system.

(2) No private water well shall be allowed within the City's corporate limits or on property that is within one mile of the City's corporate limits and within 300 feet of a water main; provided, however, any private water well in existence on or before August 1, 2003, that is within the corporate limits or one mile thereof and within 300 feet of a water main shall be permitted to continue operating until the first transfer or conveyance of the property served by such water well to occur after August 1, 2003, at which time such private water well must be closed at the property owner's expense and the property shall be hooked up to the city water supply as provided herein. The repair of existing private water wells shall require the closing of the well at the owner's expense and hooking up to the city water system as provided herein unless such repairs are strictly limited to the replacement or reconstruction of the electrical or mechanical components of the well. After August 1, 2003, replacement of the casing or reconstruction of an existing private water well that is within the City's corporate limits or one mile thereof and within 300 feet of a water main shall not be permitted but shall require the closing of the well at the owner's expense and the property shall be hooked up to the city water system as provided herein.

(3) No private water well shall be allowed within one mile of the City's corporate limits on property that is not within 300 feet of a water main without the prior approval of the City Council; provided, however, any private water well within one mile of the City's corporate limits and not within 300 feet of a water main in existence on or before August 1, 2003, shall be permitted to continue operating without the approval of City Council until the first transfer or conveyance of the property served by such water well to occur after August 1, 2003, at which time such well must be closed at the property owner's expense absent the approval of the City Council to continue operating the private well. The repair or replacement of existing private water wells within one mile of the City's corporate limits and not within 300 feet of a water main shall require the closing of the well at the owner's expense, unless such replacement or repairs are approved by the City Council.

(4) It shall be unlawful to place, maintain, construct or replace any of the following structures or conduct any of the following activities within the distance specified below from any city water well:

<i>CATEGORY</i>	<i>DISTANCE</i>
Non-potable water well	1,000 feet
Sewage lagoon	1,000 feet

<i>CATEGORY</i>	<i>DISTANCE</i>
Absorption or disposal field for waste	500 feet
Cesspool	500 feet
Dump	500 feet
Feedlot or feedlot runoff	500 feet
Corral	500 feet
Pit toilet	500 feet
Sanitary landfill	500 feet
Chemical or petroleum product storage	500 feet
Septic tank	500 feet
Sewage treatment plant	500 feet
Sewage wet well	500 feet
Sanitary sewer connection	100 feet
Sanitary sewer manhole	100 feet
Sanitary sewer line	100 feet
Sanitary sewer line (permanently watertight)	10 feet

(5) Violations of this section shall constitute a public nuisance. Any person who violates this section or refuses to comply with its enforcement shall be deemed guilty of a misdemeanor and upon conviction thereof shall be fined not more than \$500.00 for each separate offense. A new violation shall be deemed to have been committed every 24 hours of such violation or failure to comply.

(Am. by Ord. No. 963, 8/7/03)

§3-117 WATER SERVICE CONTRACTS

Contracts for water service are not transferable. Any person wishing to change from one location to another shall make a new application and sign a new contract. If any consumer shall move from the premises where service is furnished or if the said premises are destroyed by fire or other casualty, he shall at once inform the Director of Public Works, who shall cause the water service to be shut off at the said premises. If the consumer should fail to give such notice, he shall be charged for all water used on the said premises until the Director of Public Works is otherwise advised of such circumstances. (Neb. Rev. Stat. §17-537)

§3-118 INSPECTION

The Director of Public Works or his duly authorized agents shall have free access at any reasonable time to all parts of each premises and building to or in which water is delivered for the purpose of examining the pipes, fixtures, and other portions of the system to ascertain whether there is any disrepair or unnecessary waste of water. (Neb. Rev. Stat. §17-537)

§3-119 POLICE REPORTS

It shall be the duty of the City Police to report to the Director of Public Works all cases of leakage and waste in the use of water and all violations of the municipal code relating to the Water Department. They shall also enforce the observance of all such regulations.